

**SMA
PLUG**

**N
JACK
BULKHEAD**

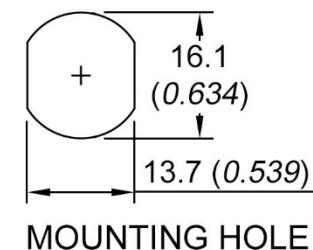
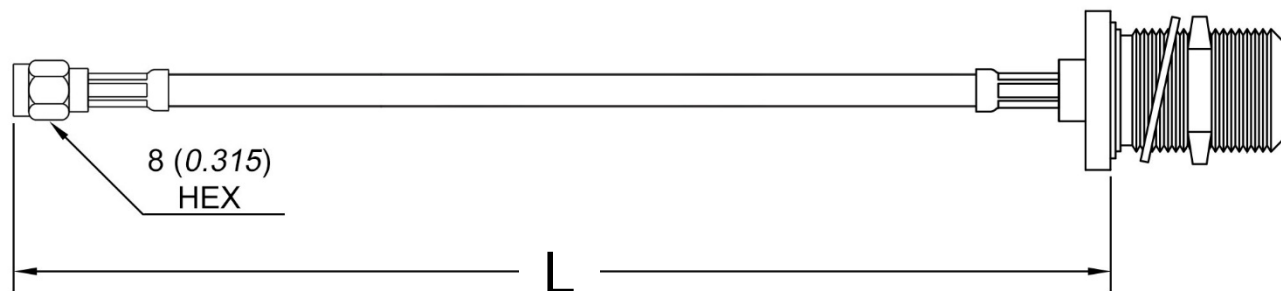

MOUNTING HOLE

MECHANICAL SPECIFICATIONS

	Type	Geometry	Material & finishing		
Connector 1	SMA plug	Straight	Gold on Nickel pl. Brass		
Connector 2	N jack bulkhead	Straight	Nickel plated Brass		
	Type	Dielectric	Jacket	Ext. diam.	Op. Temp.
Cable	LLF240 (LMR-240)	Foam PE	PVC	6.1 mm	-40/+80 °C

ELECTRICAL SPECIFICATIONS

Frequency range	DC – 3 GHz VSWR 1.22 (20 dB RL)	3 – 6 GHz VSWR 1.43 (15 dB RL)
Impedance	50 Ω	

Frequency (MHz)	Typical Attenuation (dB/m)	Frequency (MHz)	Typical Attenuation (dB/m)
50	0.06	1000	0.25
150	0.10	2400	0.42
450	0.17	5500	0.75

Part #

Standard length

N15S02-22-00500	L = 50 cm
N15S02-22-00750	L = 75 cm
N15S02-22-01000	L = 1 m
N15S02-22-01500	L = 1.5 m
N15S02-22-02000	L = 2 m
N15S02-22-03000	L = 3 m
N15S02-22-04000	L = 4 m
N15S02-22-05000	L = 5 m
N15S02-22-10000	L = 10 m

Part #

Custom length

N15S02-22-"L"	Replace L with cable length in mm
---------------	-----------------------------------



www.qaxial.com



N15S02-22 Series