

GSD

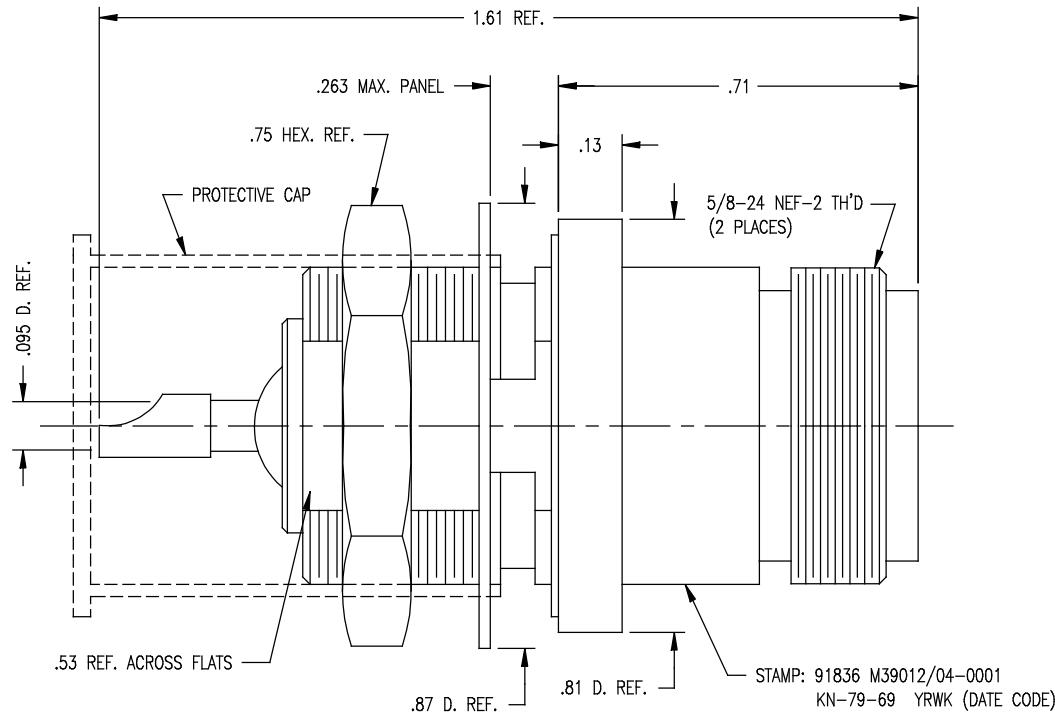

NOTES:

1. INTERFACE PER MIL-STD-348, FIG. 304-2.
2. MATERIALS:
  - INSULATOR: TEFLON, ASTM-D-4894
  - CENTER CONTACT F. BER. COPPER, ASTM-B-196
  - GASKET: SILICONE RUBBER, ZZ-R-765
  - LOCKWASHER: PHOS. BRONZE, ASTM-B-103
  - ALL OTHER METAL PARTS: BRASS, ASTM-B16
3. FINISHES:
  - CENTER CONTACT: GOLD PLATE PER MIL-C-45204
  - GLASS TERMINAL: TIN PLATE PER MIL-T-10727
  - ALL OTHER METAL PARTS: SILVER PLATE PER QQ-365
4. ELECTRICAL CHARACTERISTICS:
  - WORKING VOLTAGE: 1000 VOLTS RMS
  - FREQUENCY RANGE: DC TO 11 GHz
  - NOMINAL IMPEDANCE: 50 ~W
5. ENVIRONMENTAL:
  - LEAKAGE RATE SHALL NOT EXCEED  $10^{-7}$  CC/SEC OF TRACER GAS AT ATMOSPHERIC PRESSURE.

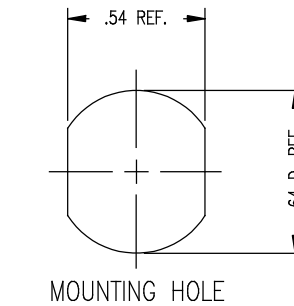

GSD

M39013/04-0001	REVISIONS	
	ISSUE	CHANGES
7	CN 32445 C KH 08/21/90	
8	CN 38201 E TML 02/14/01	
	WAS: KAX1011	KN-79-69
	SCALE 4:1	
	APPROX SURFACE AREA	
	KN-79-69	
	USED ON	
	REF:	
	RECEPTACLE, BULKHEAD, N, HERM SEAL	
	DRAWN KH	DATE 04/29/92
	DESIGN MJB	DATE 04/30/92
	APPR.	DATE
	 KINGS ELECTRONICS CO., INC. ROCK HILL, SOUTH CAROLINA 29730	
	M39012/04-0001	