

**DATASHEET**



**ELECTRICAL SPECIFICATIONS:**

Frequency range	dc - 4 GHz
Impedance	50 Ω
Voltage rating	500V rms
Insulation resistance	5000 MΩ min.
Temperature range	-65 / +85 °C
Life time	500 mating

**MATERIAL SPECIFICATIONS:**

	Materials	Finishes
Connector body	Brass	Nickel plating
Center contact	Brass	Gold plating
Ferrule	Brass	Nickel plating
Insulator	PTFE	-

**CABLE GROUP:**

RG142 / RG400 / RG223

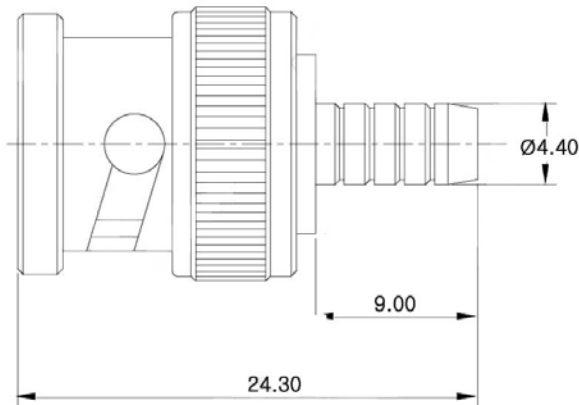

**STRIPPING (unit: mm)**

