

COAXIAL ATTENUATORS

E.S.A./S.C.C. SPACE QUALIFIED -- SMA



1 - 2 WATTS

These Space coaxial attenuators have been approved by E.S.A. (European Space Agency). They can be supplied tested to different levels of Verification Of Qualification (in accordance with E.S.A./S.C.C. specification 3403/005) testing level B1, B2 and B3.

Part Number	Freq. range (GHz)	ATTENUATION (dB)				V.S.W.R					Power (W) avg	Flatness (dB)
		Nom.	Tolerance (dB)			DC - 4	4 - 8	8 - 12.4	12.4 - 18	18 - 22		
			DC	< DC-18	18-22							
R413600000	DC - 22	0	± 0.15	± 0.30	± 0.40	≤ 1.15	≤ 1.20	≤ 1.25	≤ 1.35	≤ 1.50	2	F < 13GHz
R413601000		0.5	± 0.15	± 0.30	± 0.40	≤ 1.15	≤ 1.20	≤ 1.25	≤ 1.35	≤ 1.50	2	0.05dB/0.5GHz
R413602000		1	± 0.15	± 0.30	± 0.40	≤ 1.15	≤ 1.20	≤ 1.25	≤ 1.35	≤ 1.50	2	
R413603000		1.5	± 0.15	± 0.30	± 0.40	≤ 1.15	≤ 1.20	≤ 1.25	≤ 1.35	≤ 1.50	2	
R413604000		2	± 0.15	± 0.30	± 0.40	≤ 1.15	≤ 1.20	≤ 1.25	≤ 1.35	≤ 1.50	2	
R413605000		2.5	± 0.15	± 0.30	± 0.40	≤ 1.15	≤ 1.20	≤ 1.25	≤ 1.35	≤ 1.50	2	
R413606000		3	± 0.15	± 0.30	± 0.40	≤ 1.15	≤ 1.20	≤ 1.25	≤ 1.35	≤ 1.50	2	
R413607000		3.5	± 0.15	± 0.30	± 0.40	≤ 1.15	≤ 1.20	≤ 1.25	≤ 1.35	≤ 1.50	2	
R413608000		4	± 0.15	± 0.30	± 0.40	≤ 1.15	≤ 1.20	≤ 1.25	≤ 1.35	≤ 1.50	2	
R413609000		4.5	± 0.15	± 0.30	± 0.40	≤ 1.15	≤ 1.20	≤ 1.25	≤ 1.35	≤ 1.50	2	
R413610000		5	± 0.15	± 0.30	± 0.40	≤ 1.15	≤ 1.20	≤ 1.25	≤ 1.35	≤ 1.50	2	
R413611000		5.5	± 0.15	± 0.30	± 0.40	≤ 1.15	≤ 1.20	≤ 1.25	≤ 1.35	≤ 1.50	2	
R413612000		6	± 0.15	± 0.30	± 0.40	≤ 1.15	≤ 1.20	≤ 1.25	≤ 1.35	≤ 1.50	2	
R413613000		6.5	± 0.15	± 0.30	± 0.40	≤ 1.15	≤ 1.20	≤ 1.25	≤ 1.35	≤ 1.50	2	
R413614000		7	± 0.20	± 0.40	± 0.50	≤ 1.15	≤ 1.20	≤ 1.25	≤ 1.35	≤ 1.50	2	F > 13GHz
R413615000		7.5	± 0.20	± 0.40	± 0.50	≤ 1.15	≤ 1.20	≤ 1.25	≤ 1.35	≤ 1.50	2	0.07dB/0.5GHz
R413616000		8	± 0.20	± 0.40	± 0.50	≤ 1.15	≤ 1.20	≤ 1.25	≤ 1.35	≤ 1.50	2	
R413617000		8.5	± 0.20	± 0.40	± 0.50	≤ 1.15	≤ 1.20	≤ 1.25	≤ 1.35	≤ 1.50	2	
R413618000		9	± 0.20	± 0.40	± 0.50	≤ 1.15	≤ 1.20	≤ 1.25	≤ 1.35	≤ 1.50	2	
R413619000		9.5	± 0.20	± 0.40	± 0.50	≤ 1.15	≤ 1.20	≤ 1.25	≤ 1.35	≤ 1.50	2	
R413620000		10	± 0.20	± 0.40	± 0.50	≤ 1.15	≤ 1.20	≤ 1.25	≤ 1.35	≤ 1.50	2	
R413622000		11	± 0.20	± 0.50	± 0.60	≤ 1.15	≤ 1.20	≤ 1.25	≤ 1.35	≤ 1.50	1	F ≤ 13GHz
R413624000		12	± 0.20	± 0.50	± 0.60	≤ 1.15	≤ 1.20	≤ 1.25	≤ 1.35	≤ 1.50	1	0.07dB/0.5GHz
R413626000		13	± 0.20	± 0.50	± 0.60	≤ 1.15	≤ 1.20	≤ 1.25	≤ 1.35	≤ 1.50	1	
R413628000		14	± 0.20	± 0.50	± 0.60	≤ 1.15	≤ 1.20	≤ 1.25	≤ 1.35	≤ 1.50	1	
R413630000		15	± 0.30	± 0.50	± 0.60	≤ 1.15	≤ 1.20	≤ 1.25	≤ 1.35	≤ 1.50	1	F > 13GHz
R413632000		16	± 0.30	± 0.50	± 0.60	≤ 1.15	≤ 1.20	≤ 1.25	≤ 1.35	≤ 1.50	1	0.1dB/0.5GHz
R413634000		17	± 0.30	± 0.50	± 0.60	≤ 1.15	≤ 1.20	≤ 1.25	≤ 1.35	≤ 1.50	1	
R413636000		18	± 0.30	± 0.50	± 0.60	≤ 1.15	≤ 1.20	≤ 1.25	≤ 1.35	≤ 1.50	1	
R413638000		19	± 0.30	± 0.50	± 0.60	≤ 1.15	≤ 1.20	≤ 1.25	≤ 1.35	≤ 1.50	1	
R413640000		20	± 0.30	± 0.50	± 0.60	≤ 1.15	≤ 1.20	≤ 1.25	≤ 1.35	≤ 1.50	1	

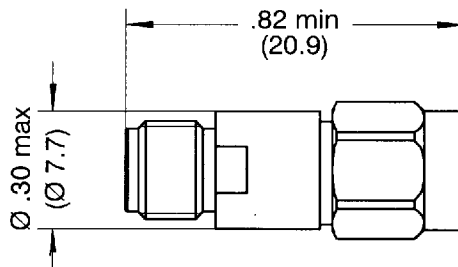
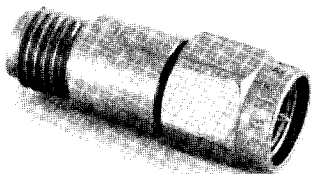

Weight : 5 g max.