

**Construction**

- Ferrite drum core, base plate and cover cap
- Electromagnetically shielded

**Features**

- Magnetically closed core shape keeps leakage and coupling low

**Packing**

- 12-mm blister tape
- Packing unit: 2300 pcs.

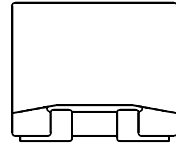
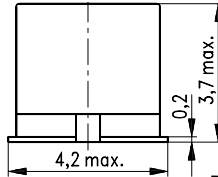

Recommended pad arrangement

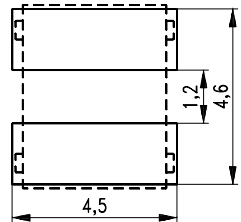
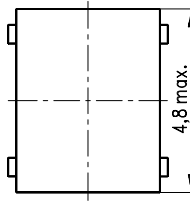

FIN0003-G

**Technical data**

| L    | L-tolerance | Q <sub>min</sub> | f <sub>M</sub> | f <sub>r</sub> | R <sub>DC</sub> | I <sub>max</sub> | Ordering code   |                 |
|------|-------------|------------------|----------------|----------------|-----------------|------------------|-----------------|-----------------|
| μH   | %           |                  | MHz            | MHz            | Ω               | mA               |                 |                 |
| 1,0  | ± 10        | 50               | 25             | 150            | 0,16            | 790              | B78008-S1102-K1 |                 |
| 1,5  |             |                  |                | 7,9            | 110             | 0,19             | 730             | B78008-S1152-K1 |
| 2,2  |             |                  |                |                | 80              | 0,25             | 630             | B78008-S1222-K1 |
| 3,3  |             |                  |                |                | 65              | 0,40             | 500             | B78008-S1332-K1 |
| 4,7  |             |                  |                |                | 55              | 0,60             | 410             | B78008-S1472-K1 |
| 6,8  |             |                  |                |                | 45              | 0,70             | 370             | B78008-S1682-K1 |
| 10   |             |                  | 34             |                | 0,90            | 310              | B78008-S1103-K1 |                 |
| 15   |             |                  | 2,5            | 26             | 1,10            | 260              | B78008-S1153-K1 |                 |
| 22   |             |                  |                | 20             | 1,50            | 210              | B78008-S1223-K1 |                 |
| 33   |             |                  |                | 16             | 1,90            | 170              | B78008-S1333-K1 |                 |
| 47   |             |                  |                | 14             | 2,50            | 140              | B78008-S1473-K1 |                 |
| 68   |             |                  |                | 13             | 4,00            | 120              | B78008-S1683-K1 |                 |
| 100  |             |                  |                | 11             | 6,00            | 100              | B78008-S1104-K1 |                 |
| 150  |             |                  | 0,79           | 9              | 7,00            | 80               | B78008-S1154-K1 |                 |
| 220  |             |                  |                | 7              | 7,00            | 65               | B78008-S1224-K1 |                 |
| 330  |             |                  |                | 6              | 11,00           | 55               | B78008-S1334-K1 |                 |
| 470  |             |                  |                | 5              | 12,00           | 45               | B78008-S1474-K1 |                 |
| 1000 |             |                  | 0,50           | 2,6            | 31,00           | 36               | B78008-S1105-K1 |                 |

Other inductance ratings upon request.

I<sub>max</sub> = Permissible current for 50 K overtemperature or ± 5 % L change

▲ = To be preferred

|   |   |
|---|---|
| Climatic category in accordance with IEC 68-1 | 55/125/56<br>(- 55 to 125 °C, 56 days damp heat test) |
| Permissible power dissipation                 | 120 W, corresponding to an overtemperature of 50 K    |

Typical coil qualities

