

Receptacle with Solder End

receptacle, female

- > bulkhead mounted
- > front mounting

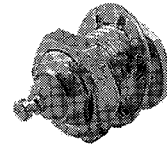
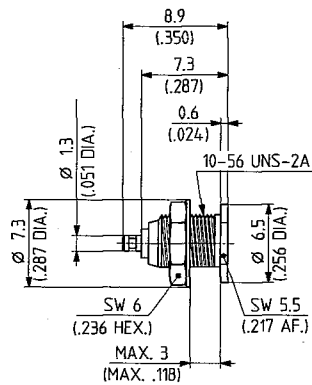

SUHNER TYPE	Ident. no.	Mounting hole	Weight	Notes
22 MCX-50-0-2	• 640171	ML 11	0.80 g/.028 oz.	not protruding

PCB Connectors

straight PCB plug

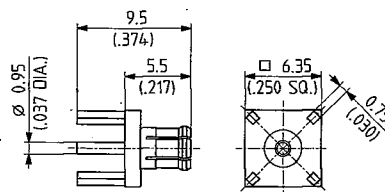

SUHNER TYPE	Ident. no.	Mounting hole	Weight	Notes
81 MCX-50-0-1	• 646253	ML 15	0.60 g/.021 oz.	without stand-offs

straight PCB jacks

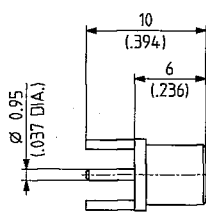

Fig. 1

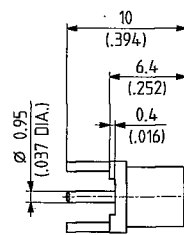
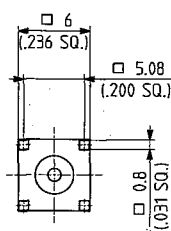
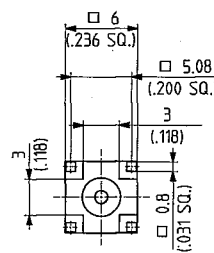

Fig. 2



SUHNER TYPE	Ident. no.	CECC	Mounting hole	Weight	Fig.	Notes
82 MCX-50-0-1/111	• 640173	22 221-806-01	ML 15	1.00 g/.035 oz.	1	gold plated, without stand-offs
82 MCX-50-0-1/133	• 641691		ML 15	1.00 g/.035 oz.	1	SUCOPLATE®, without stand-offs
82 MCX-50-0-2	• 642829		ML 15	1.00 g/.035 oz.	2	

• centre contact captivated

cable groups see page 36

assembly tools see page 403

mounting holes see page 441