

Assembly instruction

Series MCX

E10 **Nr. 9096**

Tools and materials required:

- Stanley blade
- Scissors
- Soldering iron 60 Watts
- Solder Sn/Pb 60/40
- activated rosin flux

PC-board cable terminals, straight

Cable entry: soldered

Connector types: (e. g.)

83 MCX-0-1-6	83 MCX-0-2-7
--------------	--------------

Suitable cables e. g.:

RG 178 B/U	RG 316/U
RG 196 A/U	RG 188 A/U

Braid:

soldered	soldered
----------	----------

CAUTION: Cable assembly must be completed prior to PC-board mounting.

83MCX-0-1-6

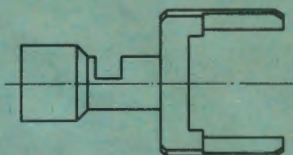

83MCX-0-2-7

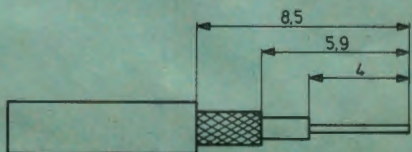
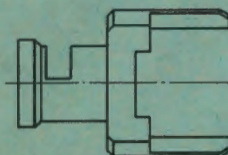

IMPORTANT: If use of shrink tube is intended, slide tube on cable prior to stripping.

Prepare cable according to diagram.

CAUTION: Do not damage braid and inner conductor of cable!

Lightly tin inner conductor.

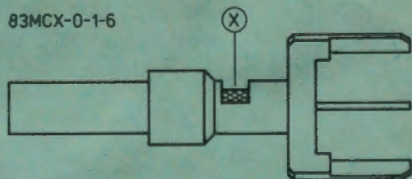

Push cable into connector to the positive stop.

Solder braid to body at opening X.

Immediately remove soldering iron to avoid melting of dielectric.

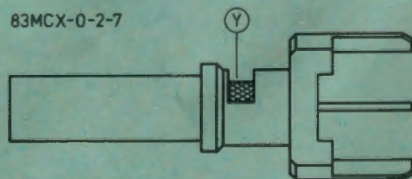

Push cable into body until cable jacket abuts against shoulder of cable entry hole.

Solder braid to body at opening Y.

Immediately remove soldering iron to avoid melting of dielectric.

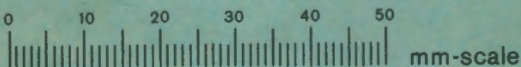

SUHNER's skilled staff and specialised equipment are available to carry out complete R.F. lead-assembly on your behalf. We mount your connectors on cables at economic prices! Please contact our representative for further details of this service.



HUBER + SUHNER Ltd. CH-9100 HERISAU

Phone 071-531515, Telex 77426

Switzerland

Deutscher Text: siehe Rückseite