

Cable Jacks

Cable entry
SUHNER Full Crimp

Taper sleeves see page 214

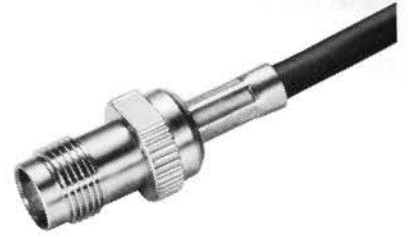
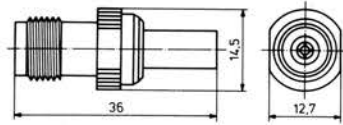

SUHNER TYPE 50 Ω	SUHNER TYPE 75 Ω	Ident. No.	US-MIL M 39012/	Cable group (example)	Crimp insert	Weight	AI	Notes
21 TNC-50-3-7c		640526	27-0005	U7 (RG58C/U)	2B	14.9 g	3015	
21 TNC-50-3-9c		641755	27-0016	U9 (RG223/U)	2B	14 g	3015	
21 TNC-50-4-6c		646897	27-0007	U16 (RG59B/U)	2C	14 g	3015	
	21 TNC-75-4-7c	642930		U16 (RG59B/U)	2C	14 g	3015	

Panel Jacks

Clamp type cable entry

Bulkhead mounted

Insulating washers for insulated mounting see page 215

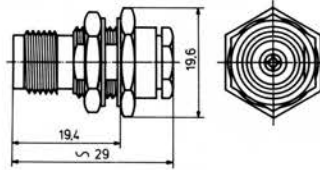

SUHNER TYPE 50 Ω	SUHNER TYPE 75 Ω	Ident. No.	US-MIL M 39012/	Cable group (example)	Weight	AI	Notes
24 TNC-50-1-1c		642264		U1 (RG196A/U)	21.5 g	3005	
24 TNC-50-2-1c		543398		U2 (RG188A/U)	21.5 g	3005	
24 TNC-50-3-3c		543406	28-0101	U7, 10(RG58C/U)	19 g	3005	

Mounting hole ML 4

Panel thickness 3.5 mm max.

Cable entry
SUHNER Full Crimp

Taper sleeves see page 214

Insulating washers for insulated mounting see page 215

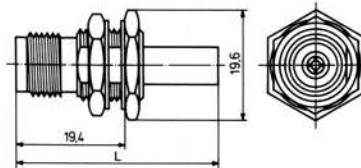

SUHNER TYPE 50 Ω	SUHNER TYPE 75 Ω	Ident. No.	US-MIL M 39012/	Cable group (example)	Crimp insert	Weight	AI	Notes
24 TNC-50-2-4c		641799		U2 (RG188A/U)	1A	17 g	9068	L = 33 mm
24 TNC-50-3-6c		640565	28-0005	U7 (RG58C/U)	2B	17.5 g	3015	L = 36 mm
24 TNC-50-3-8c		640567	28-0016	U9 (RG223/U)	2B	17.5 g	3015	L = 36 mm
24 TNC-50-4-5c		544808	28-0007	U16 (RG59B/U)	2C	18.9 g	3015	L = 36 mm
	24 TNC-75-4-8c	544140		U16 (RG59B/U)	2C	18 g	3015	L = 36 mm

Mounting hole ML 4

Panel thickness 3.5 mm max.

AI = Assembly instructions
Cable groups see page 9

Mounting holes see page 219
Assembly tools see page 205